



3, Lyons Court, Newquay, TR7 3FF

david ball
Agencies

An outstanding four-bedroom semi-detached family home, beautifully presented throughout, with a low-maintenance, south-facing garden and allocated parking. Located in the highly desirable Trevenson Meadows estate, the property also features double glazing and gas central heating.

£315,000 Freehold

Key Features

- GREAT LOCATION
- GOOD SIZED GARDEN
- GAS CENTRAL HEATING
- GOOD SIZED FAMILY HOME
- .
- PARKING
- DOUBLE GLAZING
- CLOSE TO LOCAL SCHOOLS
- SOUTH FACING GARDEN

LOCATION

Located on the Trevenson Meadows development is this four bedroom house. The current owner have maintained the property to a high standard. The town of Newquay is approximately 2 miles distance from the property and offers a comprehensive range of shopping, schooling as well as bars, restaurants and night clubs. The town also boast an historic picturesque working fishing harbour and some of Europe's finest coastline. There is a bus and rail service to outlying areas and Newquay Airport is approximately seven miles distance from the town.

HALLWAY

Double glazed door to front and hallway and doors leading to subsequent accommodation.

LOUNGE / DINER

Double glazed window to the rear aspect with double glazed patio doors leading to the rear aspect of the property. Radiator.





KITCHEN

Double glazed window to front aspect. A fitted fully integrated kitchen with a range of base, wall and drawer units with roll top work surfaces over with an inset one and quarter sink unit with a mixer tap. Inset double electric oven with 4 ring hob and extractor hood .

W/C

Low level WC with dual flush. Pedestal wash hand basin. Radiator.

BEDROOM ONE

Double glazed window to the rear aspect. Radiator.

EN-SUITE

Double glazed obscured window to the front aspect. W/C with wash hand basin. Walk in shower with shower over. Heated towel rail.

BEDROOM TWO

Double glazed window to the front aspect. Radiator.

BEDROOM THREE

Double glazed window to the front aspect. Radiator.

BEDROOM FOUR

Double glazed window to the front aspect. Radiator.

BATHROOM

The family bathroom features a full-length bath with a side panel, mixer tap, and shower attachment. Close coupled W/C. Wash hand basin. Towel rail.

EXTERNAL

Externally, the rear garden is south-facing, low-maintenance, and fully enclosed, featuring a generous lawn and a patio. Accessible from the lounge, it enjoys plenty of sunshine and is perfect for summer entertaining. The property also includes allocated parking for one vehicle.

COUNCIL TAX D

SERVICES

The following services can be found at the property: Mains electricity, gas, water and drainage, however, we have not verified any of the connections



Lyons Court, Newquay, TR7

Approximate Area = 1106 sq ft / 102.7 sq m

For identification only - Not to scale

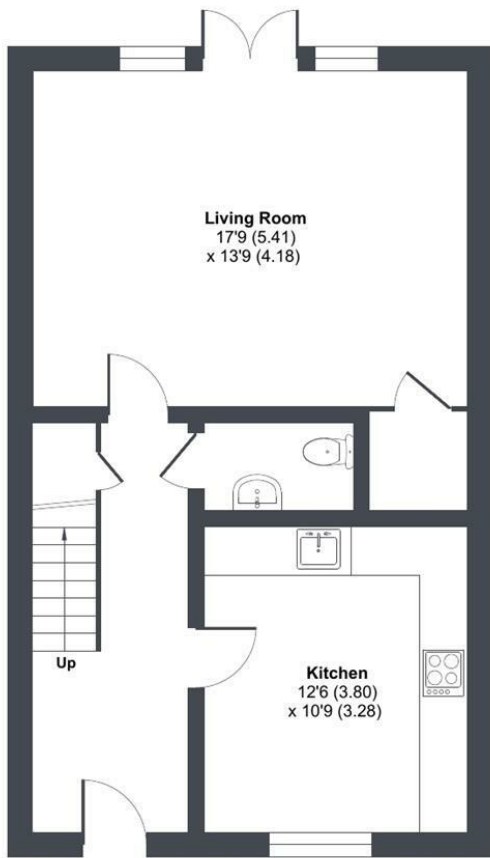

GROUND FLOOR

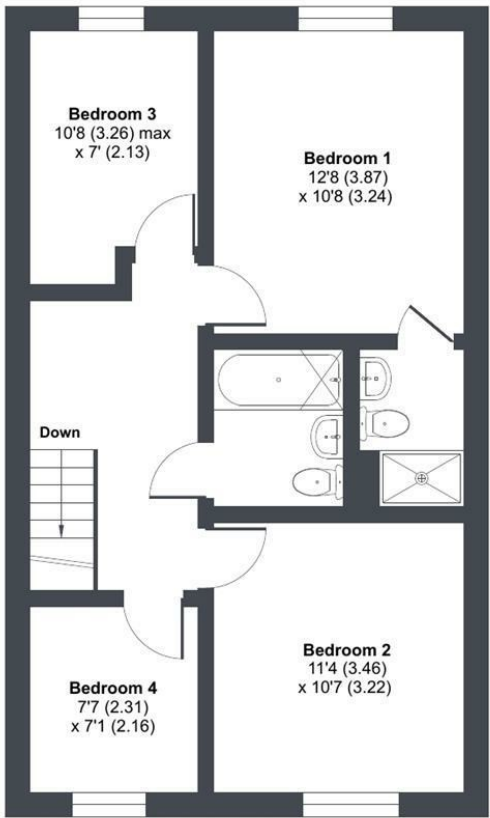

FIRST FLOOR



Floor plan produced in accordance with RICS Property Measurement 2nd Edition, incorporating International Property Measurement Standards (IPMS2 Residential). © nitchecom 2025. Produced for David Ball Agencies. REF: 1335777

Energy Efficiency Rating		
	Current	Potential
Very energy efficient - lower running costs		
(92 plus) A		
(81-91) B		
(69-80) C		
(55-68) D		
(38-54) E		
(21-38) F		
(1-20) G		
Not energy efficient - higher running costs		
England & Wales	79	83
	EU Directive 2002/91/EC	

david ball
Agencies

01637 850850

www.davidballagencies.co.uk



Connecting People & Property Perfectly

e.sales@dba.estate

34 East Street, Newquay, Cornwall TR7 1BH

1. Particulars: these particulars are not an offer or contract nor part of one. You should not rely on statements by David Ball Agencies (DBA) in the particulars or by word of mouth or in writing as being factually accurate about the property, its condition or value. Neither DBA nor any joint agent has any authority to make any representation about the property or development and accordingly any information given is entirely without responsibility in the part of the agents, sellers or lessors. 2. Images paragraphs and other information; any computer generated images, plans, drawings, accommodation schedules, specifications details or other information provided about the property ("information") are indicative only. Any such information may change at any time and must not be relied upon as being factually accurate about the property. Any photographs are indicative of the quality and style of the development and location and do not represent the actual fitting and furnishing at this development. 3. Regulations; any reference to alterations to the property or use of any part of the development is not a statement that any necessary planning, building regulations or other consents has been obtained. These matter must be verified by an intending purchaser. 4. Fixtures and fittings; supplied services and appliances have not been tested by the vendors agent. Prospective purchasers are advised to make their own enquiries. 5. All dimensions are approximates.